

5. Exploded View and Parts List

5-1. Cellular phone Exploded View

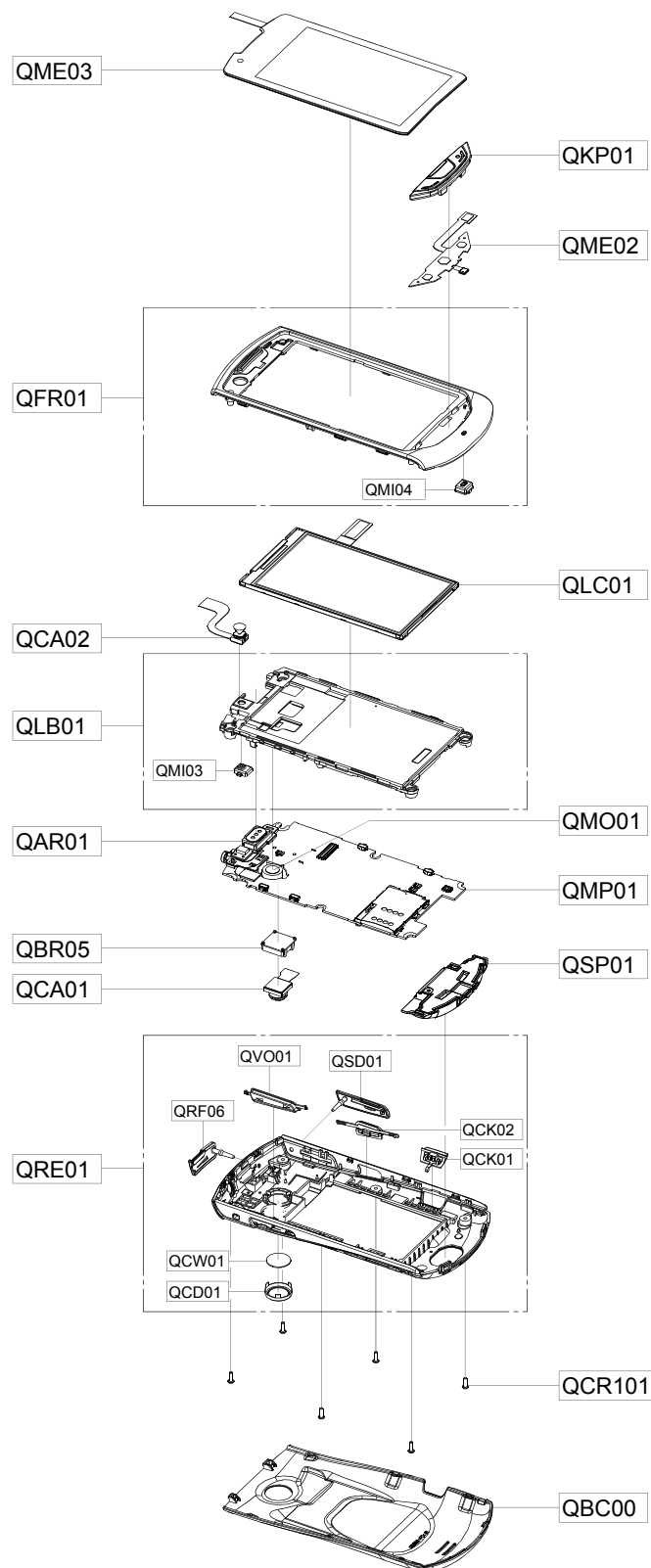

5-2. Cellular phone Parts list

Design LOC		Description	SEC CODE
QCR101		SCREW-MACHINE	6001-002005
QMO01		MOTOR DC-GT-S5620	GH31-00490A
QAR01		MODULE-EARJACK FPCB ASS'Y(S5620)	GH59-08824A
QME02		KEY FPCB-SUB_KEY PBA	GH59-08844A
QME03		TOUCH/PANEL-GT-S5620(BLK)	GH59-08846A
QSP01		MODULE-SPK+INT(GT-S5620)	GH59-08925A
QBR05		PMO BRACKET-CAMERA	GH72-57866A
QMP01		A/S ASSY-PBA MAIN,GT-S5620,XEF,FRAN(SVC	GH82-04530A
QCA02		ASSY CAMERA-MODULE,GT-S5620(CIF)	GH96-04268A
QLC01		ASSY LCD-3.0" WQVGA GT-S5620 SEMI-NUDE	GH96-04293A
QCA01		ASSY CAMERA-MODULE,GT-S5620(3M)	GH96-04300A
QKP01		ASSY KEYPAD-MAIN(EU/GREY)	GH98-15964A
QBC00		ASSY COVER-BATTERY	GH98-15967A
QLB01		ASSY BRACKET-LCD	GH98-15965A
	QMI03	RMO RUBBER-MIC TOP	GH73-13756A
QFR01		ASSY CASE-FRONT	GH98-15969A
	QMI04	RMO RUBBER-MIC BOTTOM	GH73-13755A
QRE01		ASSY CASE-REAR	GH98-15968A
	QCD01	ICT DECO-CAMERA	GH70-06019A
	QSD01	PMO COVER-MICRO SD	GH72-57820A
	QVO01	PMO KEY-VOLUME	GH72-57821A
	QCK02	PMO KEY-HOLD	GH72-57822A
	QCK01	PMO KEY-CAMERA	GH72-57823A
	QRF06	PMO COVER-MINI USB	GH72-57824A
	QCW01	PCT WINDOW-CAMERA	GH72-57825A